



**DB-3000**

Self-contained dust collector bench used in grinding and finishing operations.

- Powerful downward airflow effectively captures dust and fume
- Even air distribution provides effective dust control over the entire work surface
- Hinged side-wing panels open to accommodate longer workpieces
- Built-in fluorescent light illuminates work area
- Ergonomically designed for operator comfort
- Fibra-Web® FR filter cartridges featuring nanofiber technology provide high filtration efficiency and long filter life
- MERV\* 14 filtration efficiency rating per ASHRAE 52.2-2007
- Provides a cleaner work environment for maximum productivity
- Helps support OSHA Clean Air Standards
- Quiet operation

## DIMENSIONS & SPECIFICATIONS

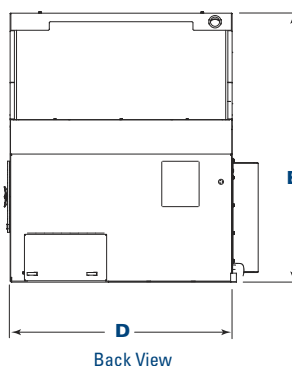
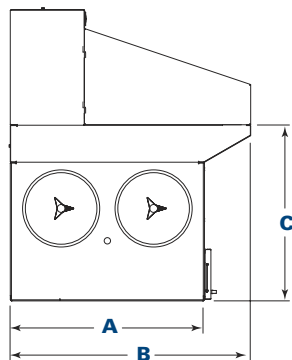

Model	Dimensions										Shipping Weight	
	A		B		C		D		E		lb	kg
	in	mm	in	mm	in	mm	in	mm	in	mm		
DB-2000	42.0	1066.8	52.0	1320.8	38.0	965.2	52.0	1320.8	63.0	1600.2	980	444.5
DB-3000	42.0	1066.8	52.0	1320.8	38.0	965.2	78.0	1981.2	63.0	1600.2	1300	589.7

Model	Nominal Airflow**		Filter Area		Motor (hp)	Downdraft Velocity		Dust Capacity		Max Load		Sound Level dB(A) <sup>†</sup>
	cfm	m <sup>3</sup> /h	ft <sup>2</sup>	m <sup>2</sup>		fpm	m/min	ft <sup>3</sup>	m <sup>3</sup>	lb/ft <sup>2</sup>	kg/m <sup>2</sup>	
DB-2000	2000	3397	240 - 508	22.3 - 47.2	3	200	61.0	1.4	0.04	75	1201.4	68
DB-3000	3000	5096	480 - 1016	44.6 - 94.4	5	200	61.0	2.8	0.08	75	1201.4	72

Note: Customer must have 90 to 100 psi clean air available. Filter area depends on the type of cartridge used.

## STANDARD FEATURES & AVAILABLE OPTIONS

STANDARD	OPTIONAL
Heavy-duty work surface supports 75 lb/ft <sup>2</sup> (1201.4 kg/m <sup>2</sup> )	Prewired controls with after-shift cleaning system
Automatic self-cleaning pulse jet system	Scratch-resistant work surfaces
Quiet, efficient backward inclined airfoil fan	Variety of Torit-Built <sup>®</sup> filter cartridges
Large capacity dust drawers	
Fibra-Web <sup>®</sup> FR cartridge	
Fluorescent light fixture	
10-year warranty	

\* The Minimum Efficiency Reporting Value (MERV) of this filter cartridge has been determined through independent laboratory testing using ASHRAE 52.2 (2007) test standards. The MERV rating was determined at a face velocity of 118 feet (36.0 meters) per minute and loading up to four inches (101.6 millimeters) water gauge. Actual efficiency of any filter cartridge will vary according to the specific application parameters. Dust concentration, airflow, particle characteristics, and pulse cleaning methods all affect filtration efficiency.

\*\* Based on clean filters.

† Sound level per ANSI S12.34.1988. The actual measured sound level will vary, depending on background noise and room conditions.

Significantly improve the performance of your collector with genuine Donaldson Torit replacement filters and parts. **Call Donaldson Torit today 800-365-1331.**



Tel 800-365-1331 (USA)  
Tel 800-343-3639 (within Mexico)

donaldsontorit@donaldson.com  
donaldsontorit.com

Donaldson Company, Inc.  
Torit  
P.O. Box 1299  
Minneapolis, MN  
55440-1299 U.S.A.

**EXACTLY WHAT YOU NEED.™**

**Downdraft Bench – DB-2000 & DB-3000 (11/12)**  
© 2000 Donaldson Co., Inc. All Rights Reserved. All products, product specifications, and data (airflow, capacity, dimensions, or availability) are subject to change without notice, and may vary by region or country. Donaldson Torit is a registered trademark of Donaldson Company, Inc. Contains Donaldson proprietary technology.